

# STANDARD BED MONITOR QUICKSTART GUIDE

English  
Deutsch

Français  
Español

Distributed by: **aidacare**  
HEALTHCARE EQUIPMENT

**INMSA-BEAM**<sup>®</sup>  
© 2008 Conseng Pty Ltd

- 1** Install  
Installer  
Anbringen  
Instalar

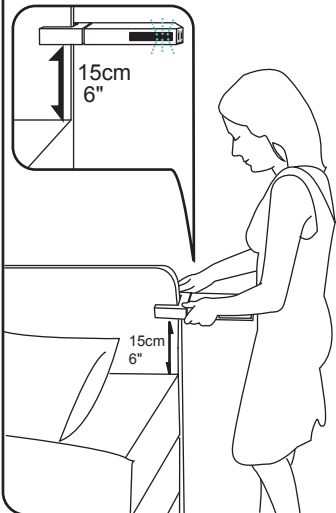

- 2** Connect to power  
Relier à la puissance  
An die Leitung anschließen  
Conectar con la energía

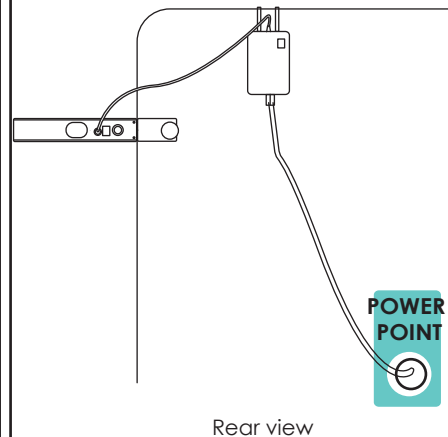

Rear view

- 3** Monitor **ON** to set beam  
Moniteur **DESSUS** pour placer le faisceau  
Monitor **AN** zum Einstellen des Lichtstrahls  
Monitor **ENCENDIDO** para fijar la viga

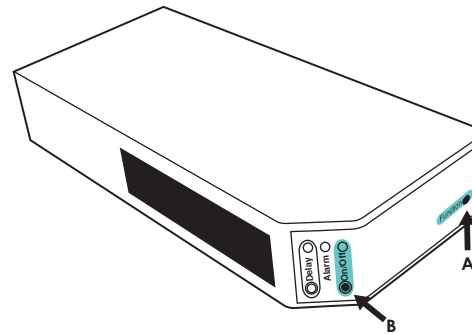

Press and hold **A** then press **B**  
Presser et tenir **A** puis presser **B**  
**A** drücken und halten, dann **B** drücken  
Presionar y sostener **A** después presionar **B**

- 4** Position the beam  
Placer le faisceau  
Den Lichtstrahl in Position bringen  
Colocar la viga

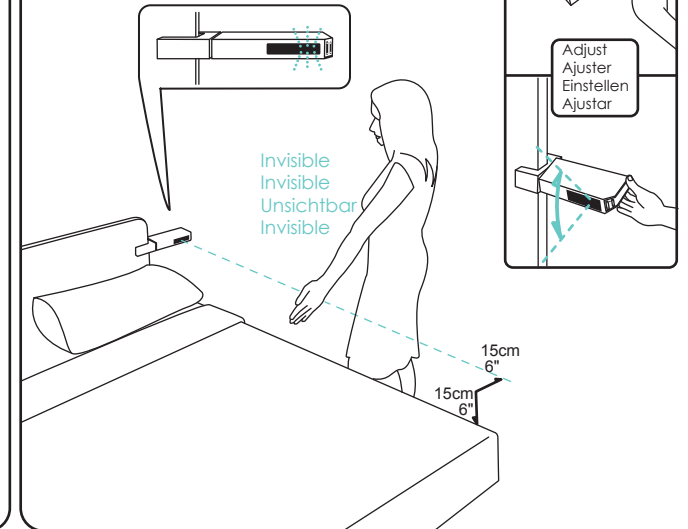

- 5** Monitor **OFF**  
Moniteur **AU LOIN**  
Monitor **ABSCHALTEN**  
Monitor **APAGADO**

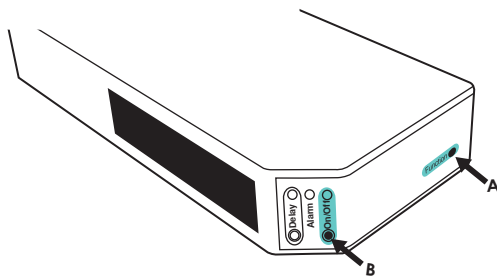

Press and hold **A** then press **B**  
Presser et tenir **A** puis presser **B**  
**A** drücken und halten, dann **B** drücken  
Presionar y sostener **A** después presionar **B**

- 6** Connect to Nurse Call  
Relier à l'appel d'infirmière  
An Krankenschwester-Anruf anschließen  
Conectar con la llamada de la enfermera

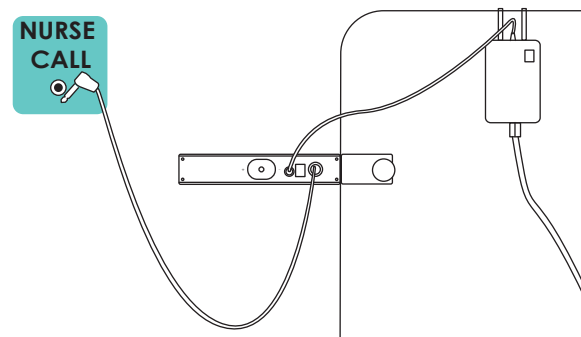

Rear view

- 7** Monitor **ON** to set alarm  
Moniteur **DESSUS** pour placer l'alarme  
Monitor **AN** zum Einstellen der Warnung  
Monitor **ENCENDIDO** para fijar la alarma

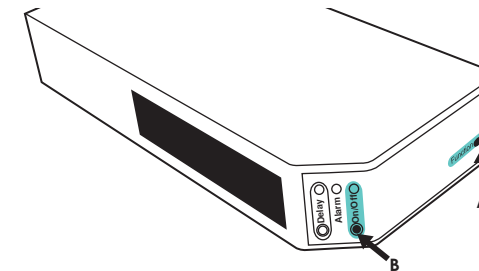

Press and hold **A** then press **B**  
Presser et tenir **A** puis presser **B**  
**A** drücken und halten, dann **B** drücken  
Presionar y sostener **A** después presionar **B**

! WARNING  
ATTENTION  
VORSICHT  
■ PRECAUCIÓN

